

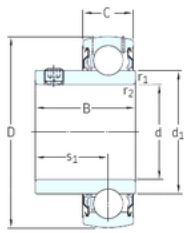

TLEE Bearing Machine Development Co.,...

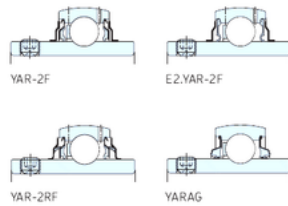

YAT



SKF YAR214-207-2F deep groove ball bearings

Bearing No. YAR214-207-2F

Size	61.913x125x69.9 mm
Bore Diameter	61,913 mm
Outer Diameter	125 mm
Width	69,9 mm
d	61,913 mm
D	125 mm
B	69,9 mm
C	28 mm
d1	87 mm
r1 min.	1,5 mm
r2 min.	1,5 mm
s1	39,7 mm
Weight	2,45 Kg
Basic dynamic load rating (C)	62,4 kN
Basic static load rating (C0)	44 kN
Fatigue load limit (Pu)	1,86

YAR214-207-2F Bearing 2D drawings and 3D CAD models